

**Technical specification**

Mounting torque: 25 Nm  
 Operating temperature: -40°C ... +125°C  
 Cable PVC: -5°C ... +60°C / Cable PUR: -20°C ... +70°C / Cable Raychem: -20°C ... +100°C  
 Media temperature: -40°C ... +125°C,  
 -25°C ... +125°C, -18°C ... +125°C, depending on seal material

**Type label description**

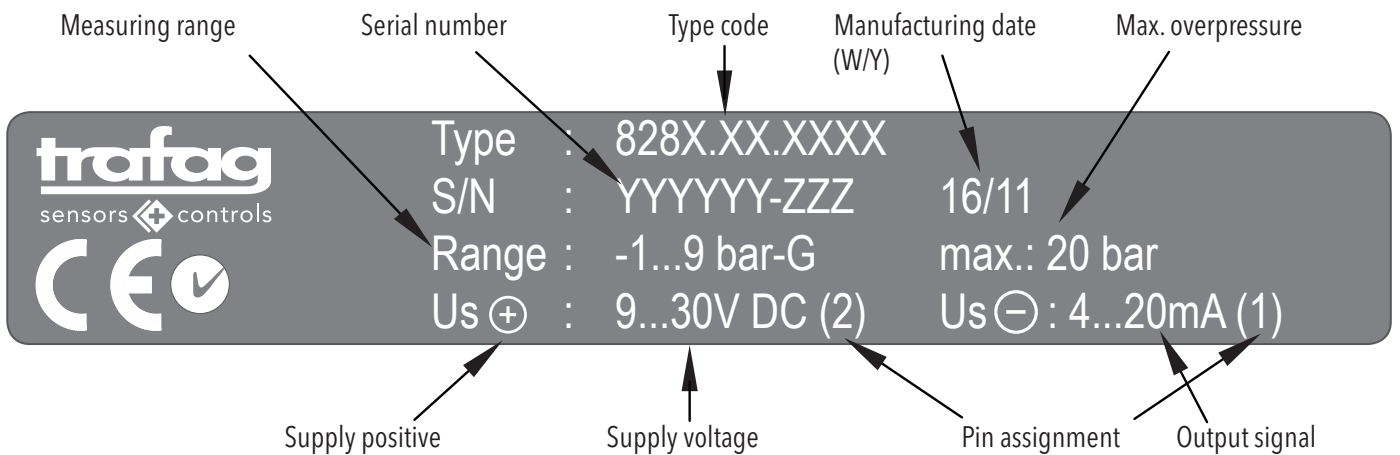

**Electrical connections**

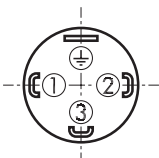
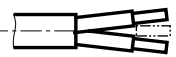
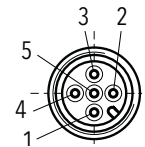
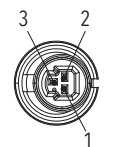
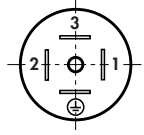
<b>Ingress Protection</b>	IP65 <sup>2)</sup> IP67 <sup>1)</sup>	IP68 max. 3m	IP67 <sup>2)</sup>	IP67 <sup>2)</sup>	IP65
<b>Designation</b>	EN175301-803A (DIN43650-A)	Cable* (PVC) (PUR) 4 x 0.25mm <sup>2</sup>	M12x1 5-pol.	Packard Metri Pack 3-pol.	Industrial Standard contact distance 9.4 mm
<b>Type code</b>	828X.XX.XXXX.05	828X.XX.XXXX.24/22/08	828X.XX.XXXX.35	828X.XX.XXXX.51	828X.XX.XXXX.01
<b>Pin configuration</b>					

**Output**

4 ... 20 mA  
 0 ... 5 VDC  
 1 ... 6 VDC  
 0 ... 10 VDC  
 0.5 ... 4.5 VDC ratiom.

**Load resistance**

(U<sub>SUPPLY</sub> - 9V) / 20mA  
 > 2.5 kΩ  
 > 5.0 kΩ  
 > 5.0 kΩ  
 ≥ 5.0 kΩ

**I<sub>SUPPLY</sub>**

< 10 mA  
 < 10 mA  
 < 10 mA  
 ≤ 10 mA

**U<sub>SUPPLY</sub>**

9 ... 32 VDC  
 9 ... 32 VDC  
 9 ... 32 VDC  
 15 ... 32 VDC  
 5 (4.75 ... 5.25) VDC

<sup>1)</sup> With Trafag IP67 connector only

<sup>2)</sup> Provided female connector is mounted according to instructions

\* Ventilation via connector. Shield in the device is not connected

## Electrical connections

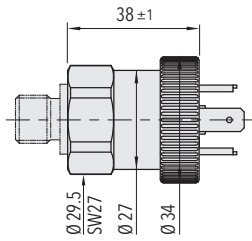

828X.XX.XXXX|05|XX.XX

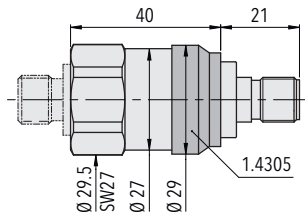

828X.XX.XXXX|35|XX.XX

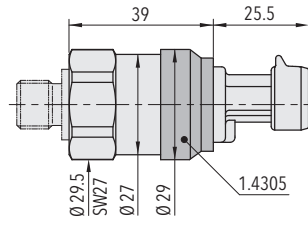

828X.XX.XXXX|51|XX.XX

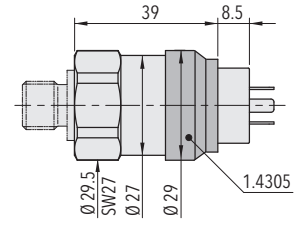

828X.XX.XXXX|01|XX.XX

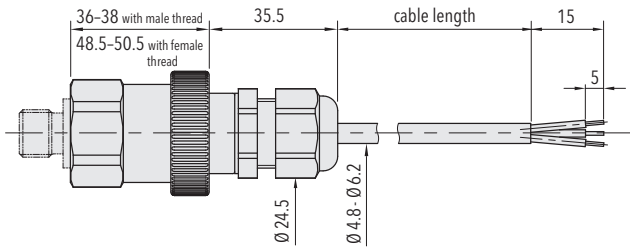

8287.XX.XXXX|24/22/08|XX.XX

## Pressure connections

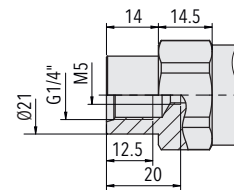

828X.XX.XX|10|XX...

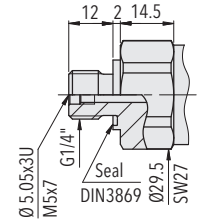

828X.XX.XX|17|XX...

## Pressure connections

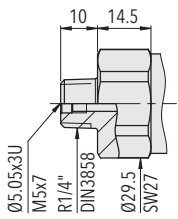

828X.XX.XX|19|XX...

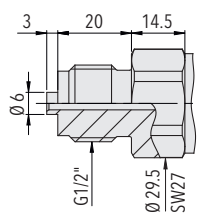

828X.XX.XX|11|XX...

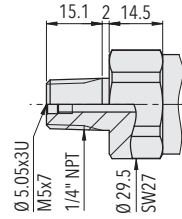

828X.XX.XX|30|XX...

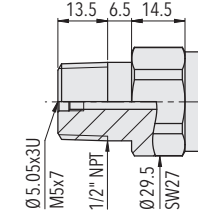

828X.XX.XX|51|XX...

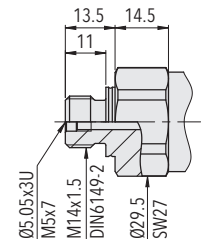

828X.XX.XX|31|XX...

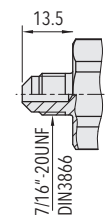

828X.XX.XX|18|XX...

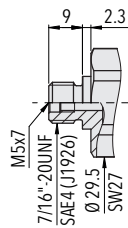

828X.XX.XX|42|XX...

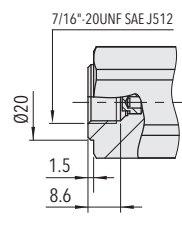

828X.XX.XX|24|XX...

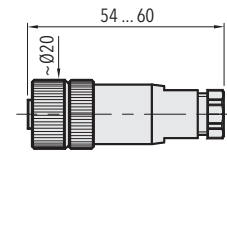

828X.XX.XXXX.XX.XX|33

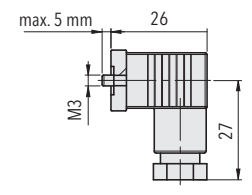

828X.XX.XXXX.XX.XX|34

## Connection of the measuring equipment

### Current output 2-wires

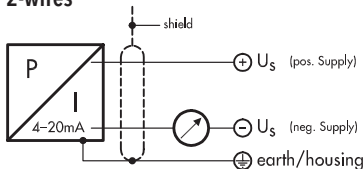

### Voltage output 3-wires

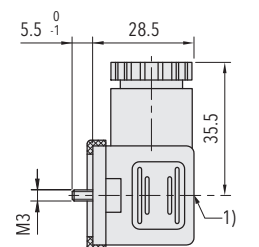
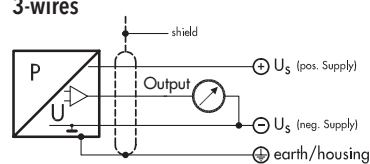

1) Tightening torque 50...60Ncm

828X.XX.XXXX.XX.XX|58