



Severe & Hazardous Area Experts

# 1600 SERIES MANUALLY OPERATED (LEVER)



- *Specifically designed for Severe Offshore Environments*
- *Compact*
- *Closed Center*
- *NACE standard on application*
- *Stainless steel internals*

### General Description

A range of compact 3/2 pilot operated spool valves in Stainless Steel for use on gases and liquids.

### Working Temperature Range

- -20°C to +180°C (-4°F to +356°F)

### Maximum Flow

- 6 bar (87 psi),  
1 bar (14.5 psi) differential
- 3/2 valves - 3500 L/min (123 SCFM)
- 5/2 valves - 3500 L/min (123 SCFM)

### Operating Medium

- *Gases* - Filtered non-lubricated air, inert, sweet (natural) gases
- *Liquids* - Low pressure hydraulic, mineral oil or water

### Ports NPT (BSP option available)

- ½" NPT
- 1/8" NPT vent port

### Working Pressure (gases & liquids)

- 12 bar (174 psi) Maximum

### Operating Force

- At 10 bar (145psi) body pressure

3/2	61N (13.7 lbf)
5/2	61N (13.7 lbf)

### Cv (Kv)

- 3/2 valves - 3.5 (53)
- 5/2 valves - 3.5 (53)

## 1600 SERIES MANUALLY OPERATED (LEVER)

### Note:

- All dimensions given in mm

### Construction Materials

- Body: 316 Stainless Steel
- Spool: 316 Stainless Steel
- Spring: 316 Stainless Steel
- Seals: Fluoroelastomer

### Lever Operated, Spring Return

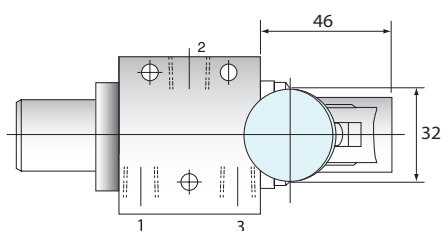

### Lever Operated with Detent

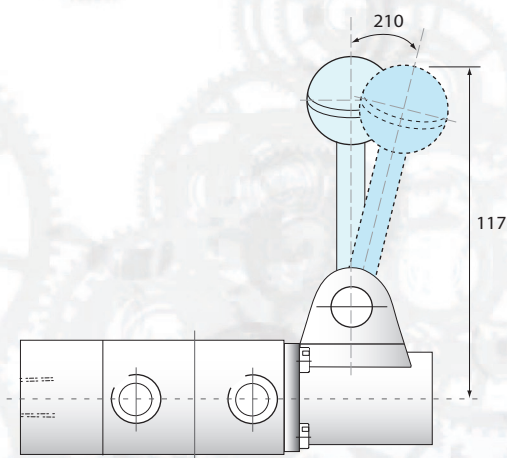
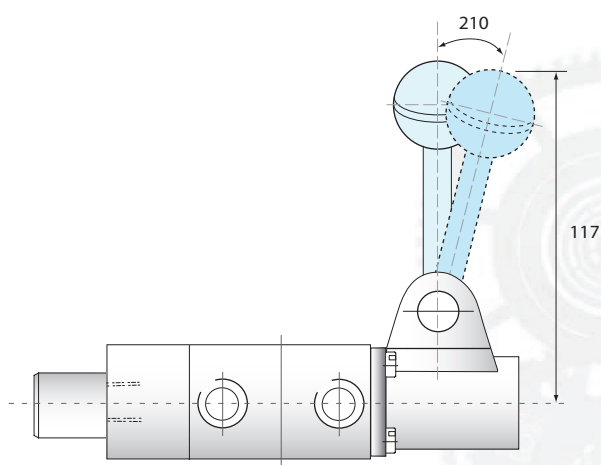
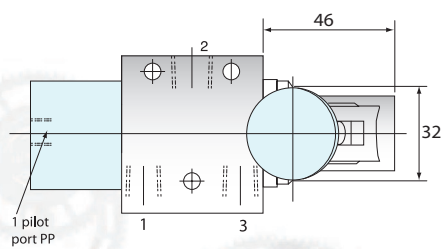

3/2 Normally  
Open



3/2 Changeover



3/2 Normally  
Closed



3/2 Diverter



5/2

