

Pressure Transmitter - ATEX certified

## TM/Ex - Passive Transmitter



### CUSTOMER BENEFITS

- Certificate: ATEX & EAC
- Unreinforced output signal
- Fast customization thanks to configurable product design
- Short response times suitable for dynamic pressure measurements

# Technical Specifications

## PRESSURE MEASURING RANGE (BAR)

	0.1 ... 0.5, (1)	> 0.5 ... 2	> 2 ... 25
Overpressure	3 bar	3 x FS ( $\geq 3$ bar)	3 x FS
Burst pressure, (5)	> 200 bar	> 200 bar	> 200 bar
Accuracy, (6) ( $\pm$ % FS)	$\leq 0.5$	$\leq 0.5 / \leq 0.25$	$\leq 0.5 / \leq 0.25$
Thermal shift, ( $\pm$ % FS/ $^{\circ}$ C)			
Zero point 0 ... 70 $^{\circ}$ C	$\leq 0.06$	$\leq 0.03$	$\leq 0.015$
Zero point -25 ... 85 $^{\circ}$ C	$\leq 0.08$	$\leq 0.04$	$\leq 0.02$
Span 0 ... 70 $^{\circ}$ C	$\leq 0.015$	$\leq 0.015$	$\leq 0.015$
Span -25 ... 85 $^{\circ}$ C	$\leq 0.02$	$\leq 0.02$	$\leq 0.02$
Response time,	< 0.1ms / 10...90% FS	< 0.1ms / 10...90% FS	< 0.1ms / 10...90% FS
Long term stability, (7)	< 0.5% FS / < 4 mbar	< 0.2% FS / < 4 mbar	< 0.1% FS / < 0.2% FS

	> 25 ... 600, (2), (4)	> 600 ... 1000, (3)
Overpressure	3 x FS ( $\leq 850 / \leq 1500$ bar)	1500 bar
Burst pressure, (5)	> 850 / $\leq 1500$ bar	> 1500 bar
Accuracy, (6) ( $\pm$ % FS)	$\leq 0.5 / \leq 0.25$	$\leq 1 / \leq 0.5$
Thermal shift, ( $\pm$ % FS/ $^{\circ}$ C)		
Zero point 0 ... 70 $^{\circ}$ C	$\leq 0.015$	$\leq 0.015$
Zero point -25 ... 85 $^{\circ}$ C	$\leq 0.02$	$\leq 0.02$
Span 0 ... 70 $^{\circ}$ C	$\leq 0.015$	$\leq 0.015$
Span -25 ... 85 $^{\circ}$ C	$\leq 0.02$	$\leq 0.02$
Response time,	< 0.1ms / 10...90% FS	< 0.1ms / 10...90% FS
Long term stability, (7)	< 0.1% FS / < 0.2% FS	< 0.1% FS / < 0.2% FS

(1) 50 mbar on request

(2) Titanium available  $\leq 400$  bar (burst pressure > 550 bar)

(3) Process connection frontal and flush diaphragm available  $\leq 600$  bar

(4) Overpressure and burst pressure 1500 bar (stainless steel) optional

(5) Transducer

(6) Zero based accuracy according to DIN-16086, incl. hysteresis and repeatability at ambient temperature

(7) 1 year (typ. / max.), the long term stability can be improved by ageing (burn-in) the sensor

## TEMPERATURE RANGE

Operating temperature	-40 ... 125 $^{\circ}$ C
Process temperatur	-40 ... 150 $^{\circ}$ C
Storage temperatur	-40 ... 125 $^{\circ}$ C

## TYPICAL OUTPUT SIGNAL (BAR)

	≤ 0.25	> 0.25...0.6	> 0.6...1
Output signal, (1), (mV)	15	25	35

	> 1...2.5	> 2.5
Output signal, (1), (mV)	50	100

(1) At nominal pressure, 10 V DC

## ELECTRICAL SPECIFICATIONS

Circuit diagram

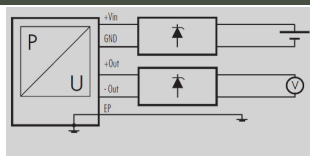

Input impedance	> 10 kΩ
Bridge resistance, (typ.)	3 kΩ
Supply voltage, (typ./max.)	10 / 15 V DC

## ATEX APPROVAL

Certificate, (1)	SEV 04 ATEX 0149		
Gas	II 1G Ex ia IIC T3 ... T6	EN 60079-0 / -11 / -26	
Dust	II 1D Ex iaD 20 I T135°C...T90°C IP6x	EN 61241-0 / -11	
Temperature class, (2)	T6	T4	T3
Ambient temperature	-25 ... 55°C	-25 ... 85°C	-25 ... 85°C
Process temperature	-25 ... 55°C	-25 ... 110°C	-25 ... 150°C
Maximum values of the connection circuit	20 V / 300 mA / 1.2 W		

(1) For detailed Ex specifications see certificate and operating an safety instructions

(2) Without any information about temperature class the transmitter will be delivered for T4

## PHYSICAL SPECIFICATIONS

Materials	
Transducer	Stainless steel (316L / 1.4435), titanium (Gr. 2), (1)
Housing	Stainless steel (316L / 1.4404), titanium (Gr. 2)
Seals	Viton (Standard), EPDM, Kalrez
Cable	PUR, FEP

(1) Hastelloy (C-276) on request

## Equipment

---

### OVERVIEW

10.00.0091	
10.00.0091	Accessories overview

## Additional documents

---

### OPERATING AND SAFETY INSTRUCTIONS

Article number	
10.88.0369	DMM030

# Ordering information

	X.	XXXX.	XXXX.	XX.	XXX
<b>Type</b>					
	TM/Ex	20			
<b>Pressure type</b>					
	Gauge	1			
	Absolute (vacuum)	2			
	Sealed gauge	3			
<b>Pressure measuring range</b>					
	50 mbar ... <100 mbar	XX			
	100 mbar ... 600 bar	XX			
	> 600 bar	XX			
	Negative ranges, offset, special adjustment	99			
<b>Process connection</b>					
	G 1/4 F, (Fig. 1)	00			
	1/4 NPT M, (Fig. 9)	10			
	1/2 NPT M, (Fig. 8)	19			
	G 1/4 M, (Fig. 2)	11			
	G 1/4 M, flush diaphragm, (4)	21			
	G 1/4 M, manometer DIN 16288, (Fig. 3)	12			
	G 1/2 M, (Fig. 4)	13			
	G 1/2 M Hastelloy C-276	41			
	G 1/2 M, frontal diaphragm, (Fig. 5), (4)	14			
	G 1/2 M, frontal diaphragm in Hastelloy C-276	37			
	G 1/2 M, flush diaphragm, (Fig. 6), (4)	15			
	G 1/2 M, manometer DIN 16288, (Fig. 7)	16			
	G 1/2 with bore Ø 14 mm	17			
	Customized connection available	99			
<b>Electrical connection</b>					
	DIN-43650 with metal threaded part, demountable, IP 65 (Fig. 10), (1)	01			
	M16 (Binder 723), 5-pin, IP 67, (Fig. 11), (1)	03			
	M16 (Binder 723), 5-pin, demountable, IP 67, (Fig. 12), (1)	43			
	MIL C26482, 10-6, IP 40, (Fig. 13), (1)	06			
	PUR cable, blue, IP 67, (Fig. 14)	17			
	FEP cable, blue, IP 67, (Fig. 14)	22			
	Customized connection available	99			
<b>Output signal</b>					
	0 ... 15 mV	10			
	0 ... 25 mV	11			
	0 ... 35 mV	12			
	0 ... 50 mV	13			
	0 ... 100 mV	14			
	0 ... XXX mV (customized)	99			
<b>Accuracy</b>					
	≤ 600 bar ≤ ± 0.5 % FS	0			
	≤ 600 bar ≤ ± 0.25 % FS (on request)	1			
	> 600 bar ≤ ± 1 % FS	5			
	> 600 bar ≤ ± 0.5 % FS	0			

<b>Temperature range</b>			
	T6 (Ta: -25 ... 55°C) 0 ... 70°C compensated (allowed process temperature: -25 ... 55°C)		0
	T4 (Ta: -25 ... 85°C) -25 ... 85°C compensated (allowed process temperature: -25 ... 110°C)		1
	T3 (Ta: -25 ... 85°C) -25 ... 85°C compensated (allowed process temperature: -25 ... 150°C)		2
<b>Option 1</b>			
	Throttle, (9)		A
	Special oil filling: Anderol Food (for food applications)		G
	Special oil filling: AS100 (suitable for media. temp -55...150°C)		J
	Special oil filling: PAO4 (silicone free)		Q
	Process connection elastomerfree		N
	Process connection welded		V
<b>Option 2</b>			
<b>Option 3</b>			
	Version titanium		K
	Seals: Viton (Standard)		U
	Seals: EPDM		S
	Seals: Kalrez (Industry)		T
	TD with 100 µm diaphragm (for hydrogen applications, Pn > 25 bar)		Z

(1) Cable socket connector not included

(4) Process connection available  $\geq 6$  bar to  $\leq 600$  bar

(9) Only with process connection Fig. 2, Fig. 3, Fig. 4, Fig. 7 and Fig. 8

# Technical drawings

## Pressure Connections

Fig. 1

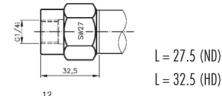

Fig. 2

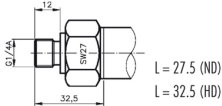

Fig. 3

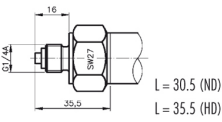

Fig. 4

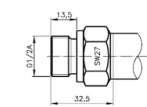

Fig. 5

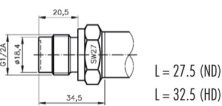

Fig. 6

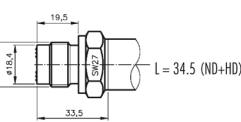

Fig. 7

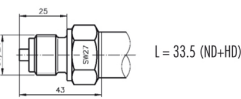

Fig. 8

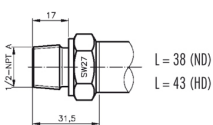
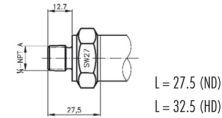
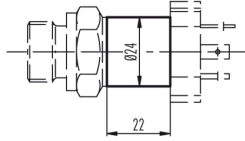

Fig. 9



L = 31.5 (ND)  
L = 36.5 (HD)

Version for media temperature up to 150°C



## Dimensions

## Electrical Connections

Fig. 10

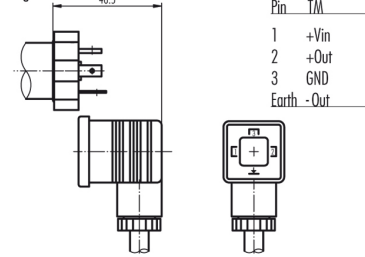

Fig. 11

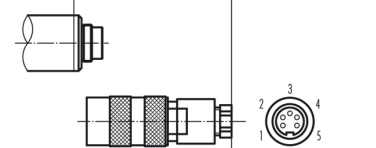

Fig. 12

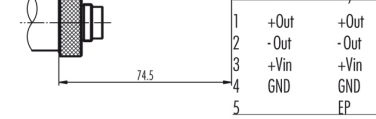

Fig. 13

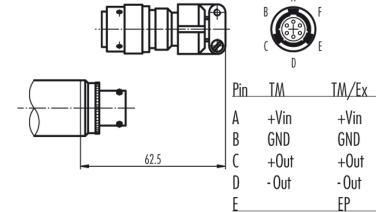
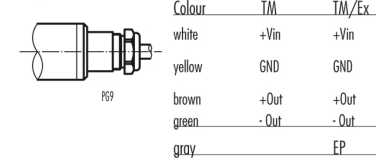

Fig. 14



Specifications may change without notice.

ST5 Headquarters, Switzerland:  
ST5 Sensor Technik, Sirmach AG  
Rüthhofstrasse 8 | 8370 Sirmach | Switzerland  
sales@st5sensors.com | www.st5sensors.com

ST5 China:  
ST5 Sensor Technology (Shanghai) Co. Ltd  
Room 2603-2606 | North Building, Fortune | 108 Square  
Lane 1839 | Qixin Road | Minhang District | Shanghai | China  
sales@st5sensors.com | www.st5sensors.com.cn

ST5 France:  
ST5 France  
844 Route de la Caille | 74350 Allonzier la Caille | France  
info-fr@st5sensors.com | www.st5sensors.fr

ST5 Germany:  
ST5 Sensoren Transmitter Systeme GmbH  
Poststrasse 7 | 71063 Sindelfingen | Germany  
info-de@st5sensors.com | www.st5sensors.de

ST5 Great Britain:  
ST5 Great Britain Ltd.  
Box 3942 | Warwick | CV34 9AE | United Kingdom  
contact@st5sensors.com | www.st5sensors.co.uk

ST5 Italy:  
ST5 Italia s.r.l.  
Via Lambro 36 | 20090 Opera (MI) | Italy  
info-italia@st5sensors.com | www.st5sensors.it